

Bi-directional 5V Low Capacitance ESD Protector

Description

The PESDWC2XD5VB protects sensitive semiconductor components from damage or upset due to electrostatic discharge (ESD) and other voltage induced transient events. They feature large cross-sectional area junctions for conducting high transient currents, offer desirable electrical characteristics for board level protection, such as fast response time, low operating voltage. It gives designer the flexibility to protect one bi-directional line in applications where arrays are not practical.

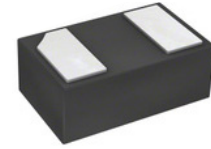

DFN0603-2L(Bottom View)

Feature

- 30W peak pulse power per line ($t_P = 8/20\mu s$)
- DFN0603-2L package
- Replacement for MLV(0201)
- Bidirectional configurations
- Response time is typically $< 1ns$
- High ESD protection
- Low clamping voltage
- RoHS compliant
- Transient protection for data lines to IEC 61000-4-2(ESD) $\pm 12KV$ (air), $\pm 10KV$ (contact); IEC 61000-4-4 (EFT) 40A (5/50ns)

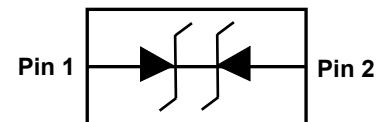

Circuit Diagram

Applications

- Cellular phones
- Portable devices
- Digital cameras
- Power supplies

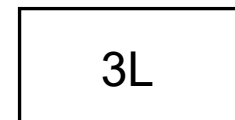

Marking (Top View)

Mechanical Characteristics

- Mounting position: Any
- Qualified max reflow temperature: $260^{\circ}C$
- Device meets MSL 1 requirements
- DFN0603-2L without plating

Electronics Parameter

Symbol	Parameter
V_{RWM}	Peak Reverse Working Voltage
I_R	Reverse Leakage Current @ V_{RWM}
V_{BR}	Breakdown Voltage @ I_T
I_T	Test Current
I_{PP}	Maximum Reverse Peak Pulse Current
V_C	Clamping Voltage @ I_{PP}
P_{PP}	Peak Pulse Power
C_J	Junction Capacitance
I_F	Forward Current
V_F	Forward Voltage @ I_F

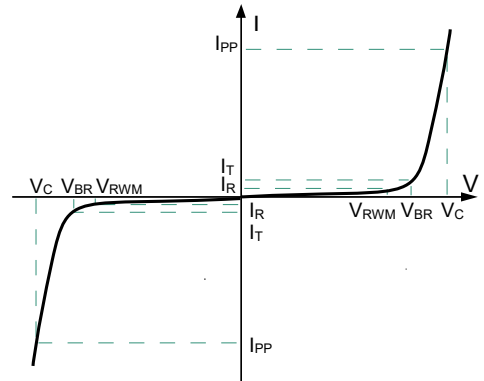

Electrical characteristics per line@25°C (unless otherwise specified)

Parameter	Symbol	Conditions	Min.	Typ.	Max.	Units
Peak Reverse Working Voltage	V_{RWM}				5	V
Breakdown Voltage	V_{BR}	$I_t = 1mA$	5.6	6.7	7.8	V
Reverse Leakage Current	I_R	$V_{RWM} = 5V$ $T=25^\circ C$			1.0	μA
Clamping Voltage	V_{CL}	$I_{PP}=16A$		13.5		V
Clamping Voltage	V_C	$I_{PP}=1A$		7	9	V
Clamping Voltage	V_C	$I_{PP}=3A$		10	12	V
Junction Capacitance	C_j	$V_R=0V$ $f = 1MHz$		3.2	6	pF

Absolute maximum rating@25°C

Rating	Symbol	Value	Units
Peak Pulse Power ($t_p=8/20\mu s$)	P_{pp}	30	W
Peak Pulse Current ($t_p=8/20\mu s$)	I_{pp}	3	A
Operating Temperature	T_J	-55 to 150	$^\circ C$
Storage Temperature	T_{STG}	-55 to 150	$^\circ C$

Typical Characteristics

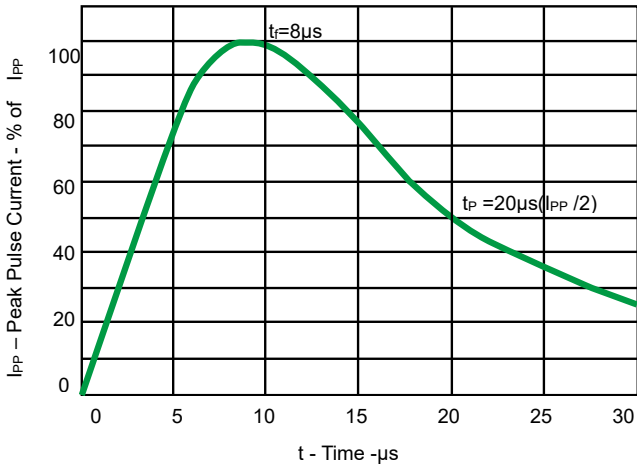

Fig 1. Pulse Waveform

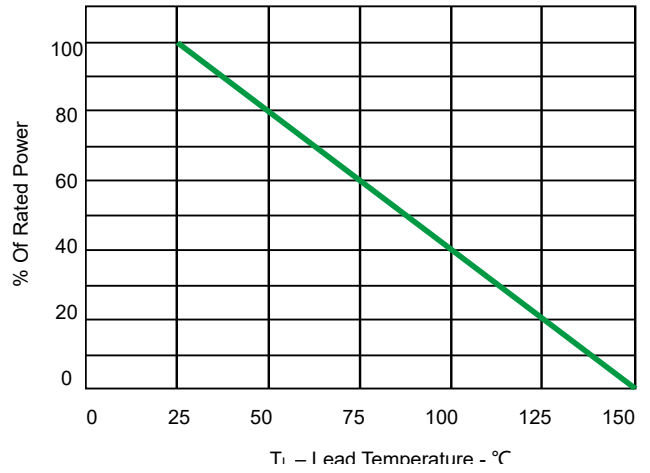

Fig 2. Power Derating Curve

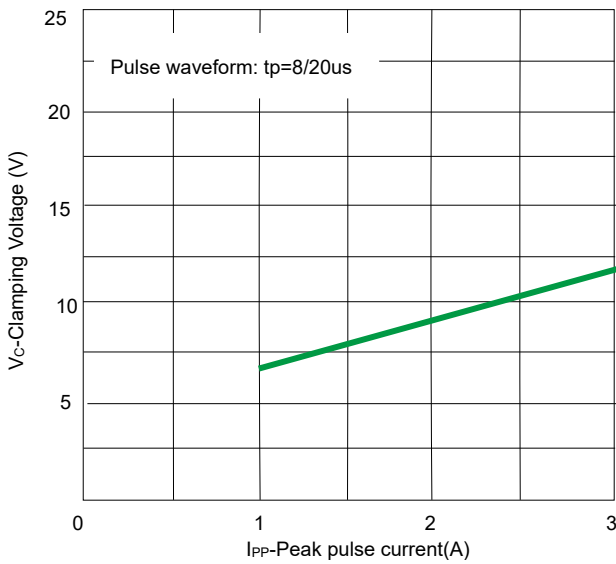

Fig 3. Clamping voltage vs. Peak pulse current

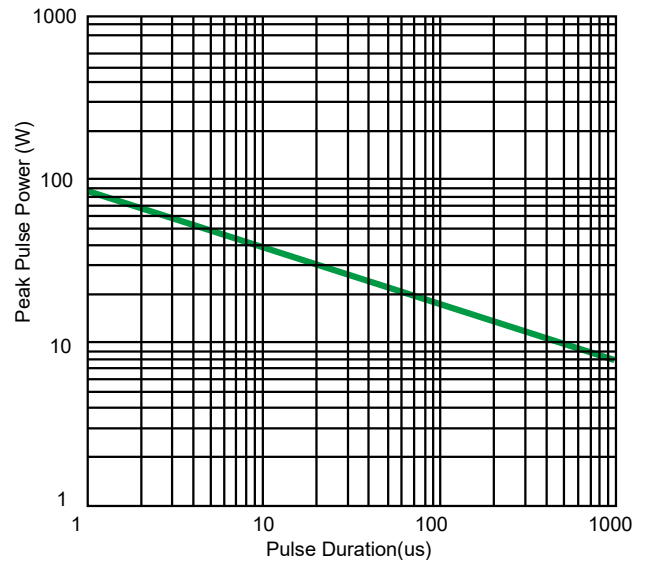

Fig 4. Non Repetitive Peak Pulse Power vs. Pulse time

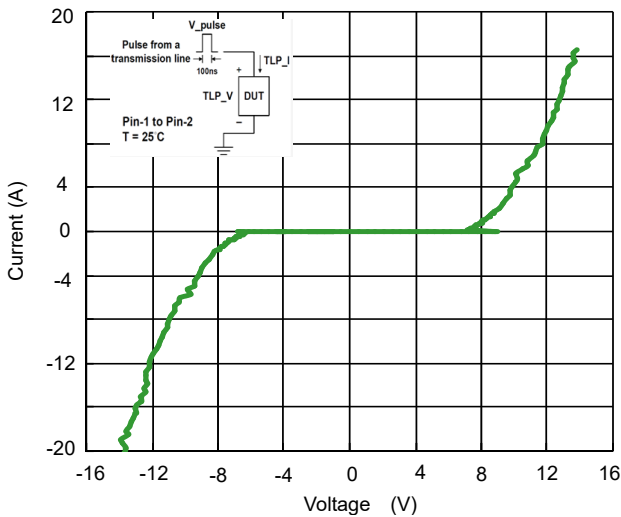

Fig 5. TLP Measurement

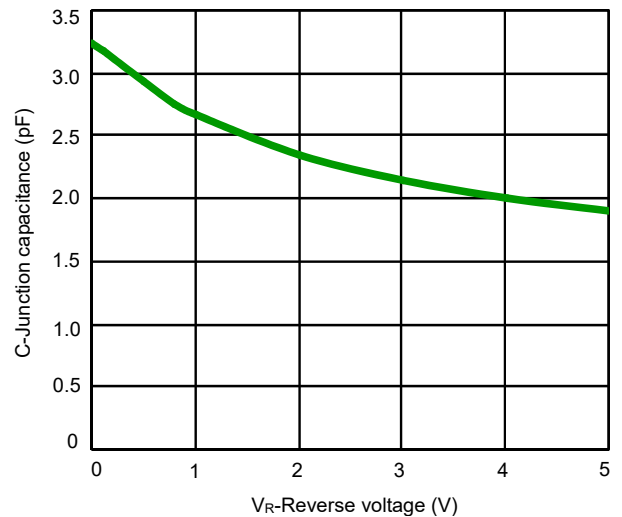
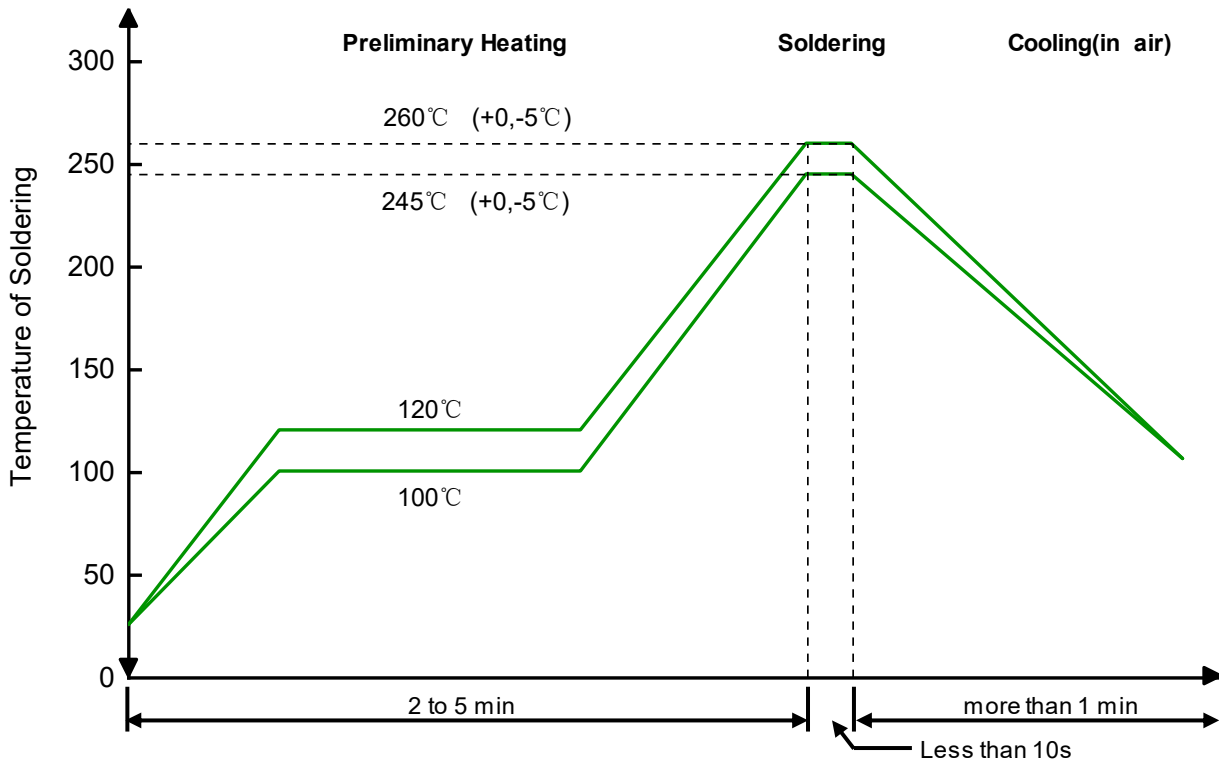

Fig 6. Capacitance vs. Reverse voltage

Solder Reflow Recommendation



Remark: Pb free for 260°C; Pb for 245°C.

PCB Design

For TVS diodes a low-ohmic and low-inductive path to chassis earth is absolutely mandatory in order to achieve good ESD protection. Novices in the area of ESD protection should take following suggestions to heart:

- Do not use stubs, but place the cathode of the TVS diode directly on the signal trace.
- Do not make false economies and save copper for the ground connection.
- Place via holes to ground as close as possible to the anode of the TVS diode.
- Use as many via holes as possible for the ground connection.
- Keep the length of via holes in mind! The longer the more inductance they will have.

Product dimension (DFN0603-2L)

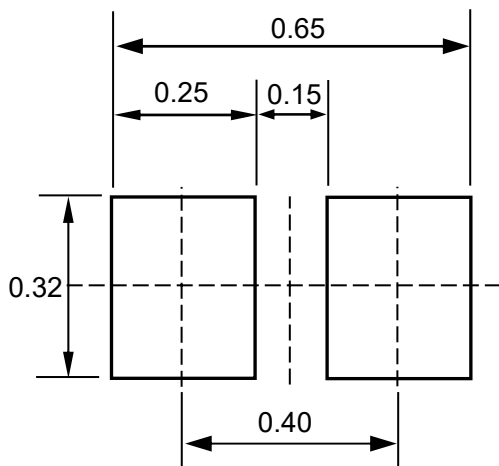
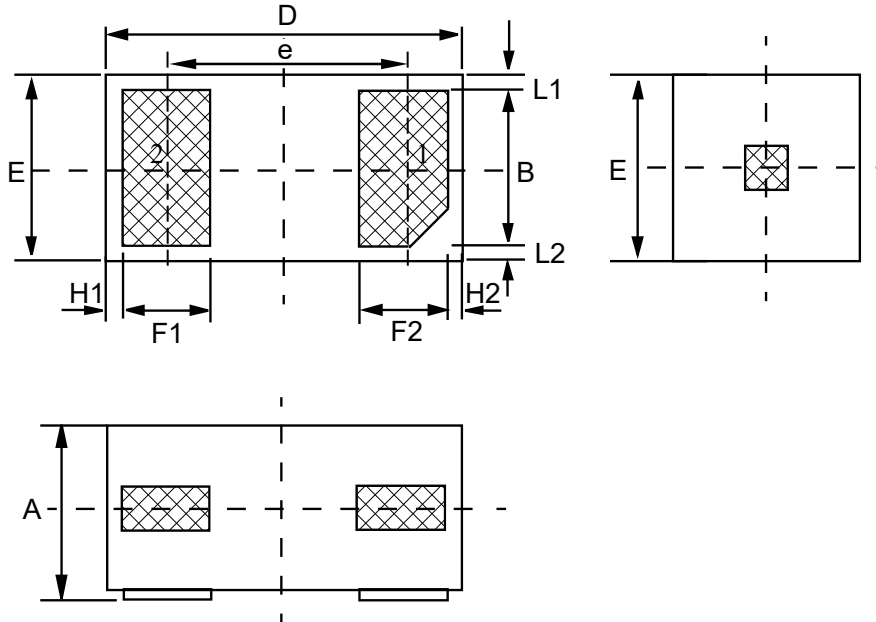

Unit:mm

Suggested PCB Layout

Dim	Millimeters		
	MIN	Typ.	MAX
A	0.270	0.300	0.340
B	0.200	0.250	0.300
D	0.550	0.600	0.650
E	0.250	0.300	0.350
e	-	0.350	-
F1	0.130	0.180	0.230
F2	0.130	0.180	0.230
L1	0.015	0.030	0.045
L2	0.015	0.030	0.045
H1	0.030	0.045	0.060
H2	0.030	0.045	0.060

Ordering information

Device	Package	Reel	Shipping
PESDWC2XD5VB	DFN0603-2L (Pb-Free)	7"	10000 / Tape & Reel

Load with information

